

SIGNATURE

CHAIR SHADE

SPECIFICATIONS

WEIGHT: 7 LBS

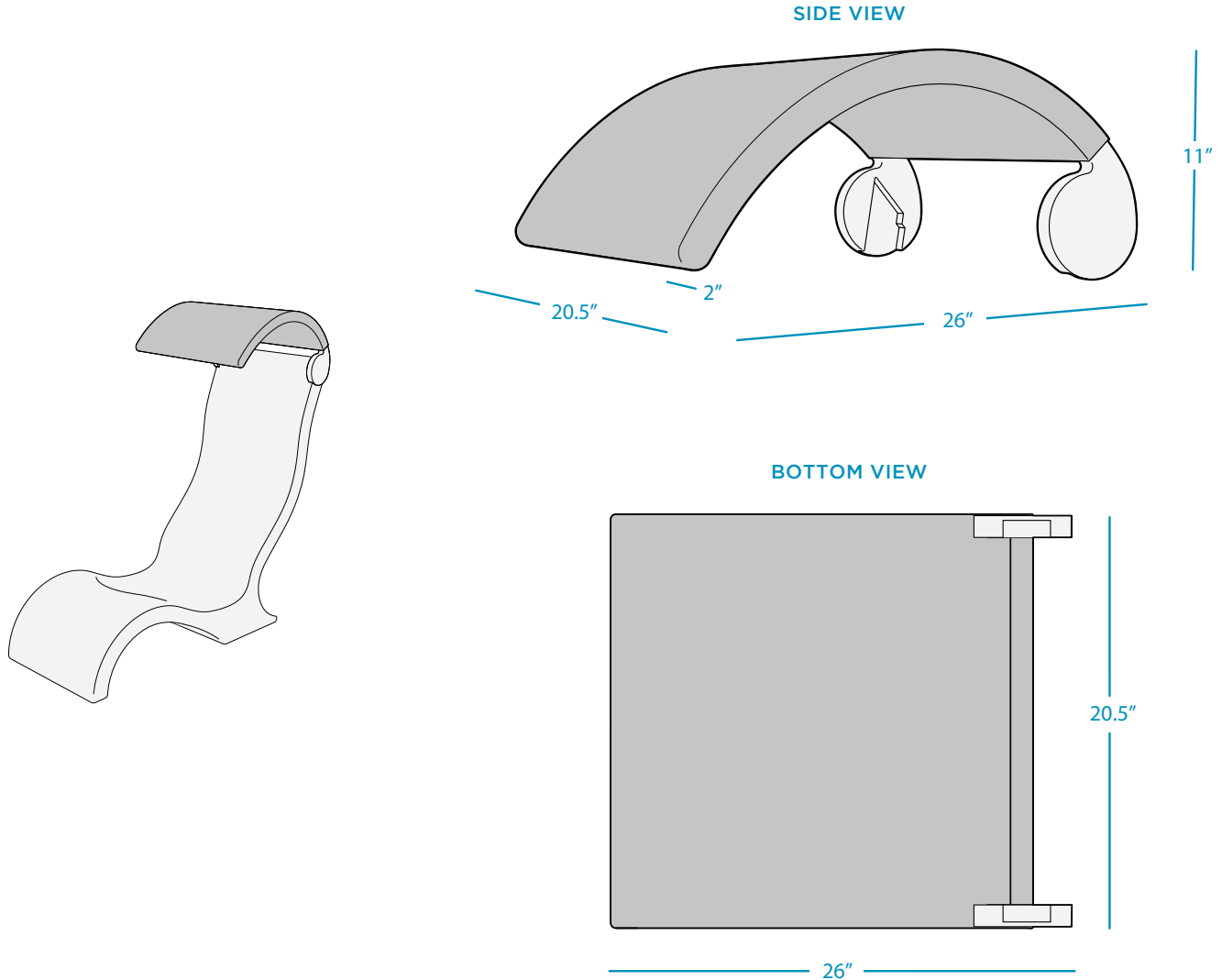

FEATURES

- Designed for the Signature Chair
- Perfect for residential or commercial use
- Built to withstand the sun, weather, and chemicals of any pool or outdoor environment
- Crafted of UV resistant materials and high quality, outdoor fabrics
- Easy slide on, slide off installation via interior grooves
- Customize with optional embroidery

AVAILABLE FRAME COLORS



AVAILABLE FABRICS

Available in marine or sling grade fabric. Website or catalog for details.

- COM available. Requires 2 yards per shade.